

宗地图

单位: m · m²

320211006014GB00028

北

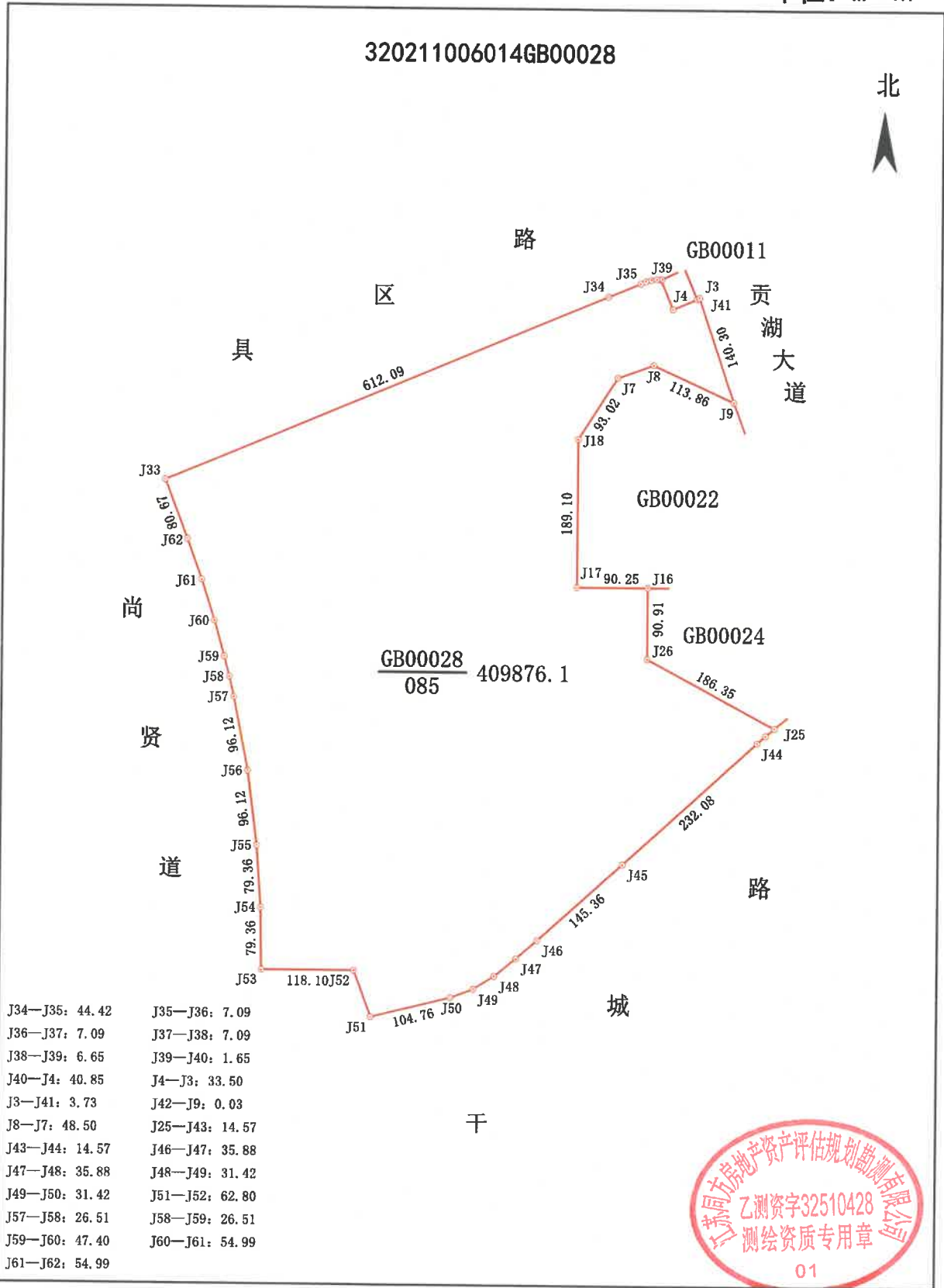

绘图员: 周正

1:7500
审核员: 杜乐乐

2023年7月3日



界址点成果表

宗地号 320211006014GB00028

权利人

宗地面积 (平方米) 409876.1

折合亩

614.82

界址点坐标

顺序号	点号	坐标		边长 (m)	备注
		X (m)	Y (m)		
1	J33	3482548.730	40530241.643	612.09	
2	J34	3482785.956	40530805.888	44.42	
3	J35	3482802.921	40530846.946	7.09	
4	J36	3482805.855	40530853.402	7.09	
5	J37	3482807.590	40530860.280	7.09	
6	J38	3482808.599	40530867.301	6.65	
7	J39	3482808.855	40530873.946	1.65	
8	J40	3482808.206	40530872.429	40.85	
9	J4	3482770.643	40530888.474	33.50	
10	J3	3482783.803	40530919.281	3.73	
11	J41	3482785.268	40530922.711	140.30	
12	J42	3482652.570	40530968.258	0.03	
13	J9	3482652.594	40530968.250	113.86	
14	J8	3482699.257	40530864.395	48.50	
15	J7	3482682.963	40530818.716	93.02	
16	J18	3482604.411	40530768.889	189.10	
17	J17	3482415.309	40530768.889	90.25	
18	J16	3482415.309	40530859.134	90.91	
19	J26	3482324.400	40530859.134	186.35	
20	J25	3482236.879	40531023.657	14.57	
21	J43	3482227.319	40531012.663	14.57	



界址点成果表

宗地号 320211006014GB00028

权利人

宗地面积 (平方米) 409876.1

折合亩

614.82

界址点坐标

顺序号	点号	坐标		边长 (m)	备注
		X (m)	Y (m)		
21	J43	3482227.319	40531012.663	14.57	
22	J44	3482217.605	40531001.805	232.08	
23	J45	3482061.628	40530829.962	145.36	
24	J46	3481963.934	40530722.329	35.88	
25	J47	3481940.312	40530695.322	35.88	
26	J48	3481917.700	40530667.464	31.42	
27	J49	3481901.049	40530640.817	31.42	
28	J50	3481890.315	40530611.285	104.76	
29	J51	3481865.036	40530509.618	62.80	
30	J52	3481923.837	40530487.564	118.10	
31	J53	3481923.943	40530369.462	79.36	
32	J54	3482003.288	40530367.827	79.36	
33	J55	3482082.441	40530362.068	96.12	
34	J56	3482177.748	40530349.590	96.12	
35	J57	3482272.079	40530331.133	26.51	
36	J58	3482297.866	40530325.001	26.51	
37	J59	3482323.542	40530318.423	47.40	
38	J60	3482369.161	40530305.549	54.99	
39	J61	3482421.552	40530288.847	54.99	
40	J62	3482473.308	40530270.266	80.67	
41	J33	3482548.730	40530241.643		



绘图员: 周正

审核员: 杜乐乐